

# **STEWART LIMOUSIN 2019 BULL SALE**

**MONDAY FEBRUARY 18 2019**  
**AT THE FARM SOUTHEAST OF STETTLE**

**MUSCLE • FERTILITY  
DOCILITY • YIELD**







We would like to welcome everyone to the Stewart Limousin Bull Sale.

We are a family run operation located south east of Stettler, Alberta.

Our family has been breeding Limousin stock since 1970, when Wilbur Stewart brought heifers over from France. For many years Grandpa Wilbur had the "Unsurpassed Sirloin Sale", where many of the Limousin bloodlines stem from. Our last auction sale was held March 1995. After selling by private treaty for many years we decided to switch gears and start the

**STEWART LIMOUSIN BULL SALE.**

We are very excited for you to join us in this journey.

Our goal is to bring quality bulls to the commercial producer and breeding stock operations that have muscle, fertility, docility and yield, and we feel we have done just that. We hope that you as a cattle producer find a bull in our program that works well with your cows to produce quality calves with tons of marketability for feedlots and desired maternal characteristics for your replacement pens.



*Join us for Lunch at 11:30am,  
Sale will start at 1:00pm*

*Videos will be available on our  
website at [stewartlimousin.com](http://stewartlimousin.com)*

**Auctioneer** Danny Skeels 403-783-1217

**Ringmen** Kirk Goldsmith 403-575-5654  
Terry Silbernagle 403-318-5873

**Sale Day Phone Numbers** Murray Cell 403-742-9813  
Ryan Cook 780-818-3452  
Tyler Cell 403-741-9571

**Hotel Accomodations in Stettler** Canalta 888-742-5808  
Ramada 403-742-6555

### Sale Format

This will be a video sale. Bulls will be on site for viewing but not ran through a ring.

### Sale and Terms and Conditions

Cattle sell under the standard terms and conditions of the Canadian Limousin Association.

### Trucking/Delivery

\$150 off if bull is taken sale day. Free delivery within 500km of the ranch.  
Trucking arrangements can be co-ordinated for additional distances at cost of buyer.  
Any bulls left at the farm must be insured and will be boarded for free until May 1, 2019, After that date a charge of \$3.00 a day per head will apply.

### Viewing of Cattle

Open House Sunday, February 17, 2019  
or can be viewed anytime if arranged.

### Directions

Go East of Stettler on Highway 12 for 4 miles to RR 19-1,  
then South 4.5 miles.  
We are located on the West side of the road.

### Volume Discount

3% on purchase of 3 bulls or more  
5% on purchase of 5 bulls or more

### Sale Announcements

Information in catalogue is believed to be accurate as of printing. Sale day announcements by consignors or sales staff will take precedence over information appearing in this catalogue.

### Insurance

Stockmens Insurance Agent - Karen Bouchard 403-501-1326

Can't make it to the sale? **Watch & Bid Online.**

With DLMS you can Watch, Listen & Bid on your computer just like you were there with online bidding over the internet

#### Instructions for Viewing And Bidding At the Sale

Visit [www.dlms.ca](http://www.dlms.ca), Fill out the registration form located under registration and sign-up for your free user account to select a username and password.

**BIDDERS** - To be approved as a bidder, Log in and click BUYER APPROVAL tab, select the sale you are interested in bidding at and click sign up.

For more information or for help getting approved Call:  
Whitney Bosovich 780.991-3025 or Mark Shologan - 780-699-5082

Direct Livestock Marketing Systems  
We're Making the Connection

**DLMS**  
[www.dlms.ca](http://www.dlms.ca)

To find an agent or sale near you today  
visit [www.dlms.ca](http://www.dlms.ca)

Purebred Sales • Daily Presort Sales  
Direct Off-farm Sales every Thursdays at 10:00 am

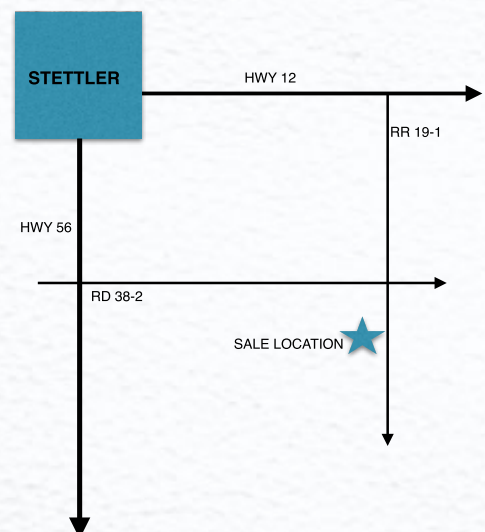





## PINNACLES ALL IN 12A REFERENCE SIRE OF LOTS 1,2

We purchased ALL IN from the Combest Limousin dispersal sale. We used ALL IN for a couple years until he was injured. He was a heavy muscled, small boned, calving ease bull that worked well on our second calvers. His progeny are moderate framed and heavy muscled. The heifers have nice udders with quality milk.



### Lot 1 SIRLOIN FERNANDO SFL 41F

February 13, 2018 CPM4096343 Red • Scurred

WULFS XTRACTOR X233X

Sire: PINNACLES ALL IN 12A  
TMF MISS 2X

DC XCALIBUR

Dam: SIRLOIN AUTUMN  
SIRLOIN YIELDER 129Y

EPD'S:	BW	WW	YW	MK	Actual BW	Wean Weight
	-1.0	51	78	25	87	786

- Super Docile • Deep • Calving Ease In Pedigree
- Could Be Used On Heifers

### Lot 2 SIRLOIN FIRE CAT SFL 56F

February 16, 2018 CPM4096346 Red • Polled

WULFS XTRACTOR X233X

Sire: PINNACLES ALL IN 12A  
TMF MISS 2X

SIRLOIN KICKOFF

Dam: SIRLOIN MESSAGE  
SIRLOIN KATHY

EPD'S:	BW	WW	YW	MK	Actual BW	Wean Weight
	-3.4	44	65	30	79	727

- Heavy Muscled • Calving Ease • Docile • Big Milk EPD
- Raised By 17 Year Old Dam • Could Be Used On Heifers





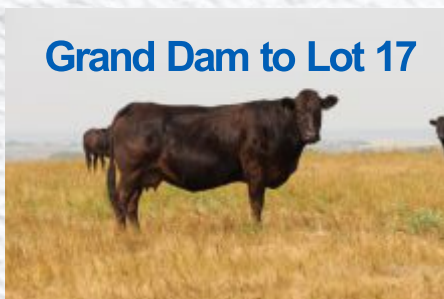

## DC COMANCHE 78C REFERENCE SIRE OF LOTS 3,4

COMANCHE was a bull we purchased from DC farms for a heifer bull. He worked very well for 3 years. Comanche's calves are deep bodied, thick, and have awesome muscle shape. He now is working on our 900 head commercial ranch.



### Lot 3 SIRLOIN FLAME SFL 1F

January 5, 2018 CPM4096339 Red • Double Polled

Sire: DC COMANCHE 78C  
DC SWEET SURRENDER

Dam: SIRLOIN DIXIE  
SIRLOIN WHIRLWIND

EPD'S:	BW	WW	YW	MK	Actual BW	Wean Weight
	0.1	54	82	24	63	585

- Tons Of Hair • Super Docile • Calving Ease
- Great Shape • Could Be Used On Heifers

### Lot 4 SIRLOIN FIDDLER SFL 55F

February 16, 2018 CPM4096345 Red • Double Polled

Sire: DC COMANCHE 78C  
DC SWEET SURRENDER

Dam: SIRLOIN DORY  
SIRLOIN WHISPER 22W

EPD'S:	BW	WW	YW	MK	Actual BW	Wean Weight
	-1.4	44	67	28	72	573

- Lots Of Hair • Great Shape
- Calving Ease • Could Be Used On Heifers





We purchased BRAVEHEART from Diamond C Limousin as a 2 year old for \$20,000 half interest in 2016 and absolutely love how he turned out. Braveheart is really something special. He is heavy muscled, has great depth, super docile, tons of performance and has a ton of hair. This year is the first year we have milking females off Braveheart and they do not disappoint. They are all very docile, have tons of depth and rib, awesome shape, great muscle and have beautiful udders with lots of milk. Braveheart's bull calves also have not disappointed. They are heavy muscled, deep, thick and super docile. We are excited to be calving his 3rd set of calves this year and know they will continue to perform.

REFERENCE SIRE OF LOTS 5 - 25



## Lot 5 SIRLOIN FIRESTONE SFL 60F

February 18, 2018 CPM4096347 Red • Scurred

EXCEL POLLED POPEYE  
Sire: DIAMOND C BRAVEHEART  
DIAMOND C UNDIES

DIAMOND C RAZZAMATAZZ  
Dam: SIRLOIN X-GIRL  
SIRLOIN MEAGAN

EPD'S:	BW	WW	YW	MK	Actual BW	Wean Weight
	5.1	72	105	18	108	825

- Lots Of Hair • Big Hipped
- Tons Of Performance • Great Pedigree





## Lot 6 SIRLOIN ELVIS SFL 35E

February 24, 2017 CPM4090491 Red • Homo Polled

EXCEL POLLED POPEYE  
Sire: DIAMOND C BRAVEHEART  
DIAMOND C UNDIES  
DC XCALIBUR  
Dam: SIRLOIN ARIEL  
SIRLOIN YIELDER 97Y

EPD'S:	BW	WW	YW	MK	Actual BW	Wean Weight
	0.0	58	87	24	86	814

- Lots Of Hair • Super Calving Ease On Dam Side
- Could Be Used On Heifers



## Lot 7 SIRLOIN EMPIRE SFL 57E

March 1, 2017 CPM40900493 Red • Double Polled

EXCEL POLLED POPEYE  
Sire: DIAMOND C BRAVEHEART  
DIAMOND C UNDIES  
NORDAL TRAILWAYS  
Dam: SIRLOIN ZENNA SFL 12Z  
SIRLOIN TRANQUIL

EPD'S:	BW	WW	YW	MK	Actual BW	Wean Weight
	4.4	60	89	15	100	665



## Lot 8 SIRLOIN EXTRACTOR SFL 58E

March 2, 2017 CPM40900494 Red • Double Polled

EXCEL POLLED POPEYE  
Sire: DIAMOND C BRAVEHEART  
DIAMOND C UNDIES  
DC XCALIBUR  
Dam: SIRLOIN ASHLEY SFL 3A  
SIRLOIN YIELDER 51Y

EPD'S:	BW	WW	YW	MK	Actual BW	Wean Weight
	0.6	57	85	22	91	737



## Lot 9 SIRLOIN EXCELLER SFL 64E

March 3, 2017 CPM4090495 Red • Double Polled

EXCEL POLLED POPEYE  
Sire: DIAMOND C BRAVEHEART  
DIAMOND C UNDIES  
ANCHOR B POWeplay  
Dam: SIRLOIN TENDER 59T  
SIRLOIN LIFELINE

EPD'S:	BW	WW	YW	MK	Actual BW	Wean Weight
	5.8	59	85	20	115	698

- Heavy Muscle • Deep • Thick • Great Pedigree





## Lot 10 SIRLOIN ECLIPSE SFL 76E

March 5, 2017 CPM4090498 Red • Double Polled

EXCEL POLLED POPEYE  
Sire: DIAMOND C BRAVEHEART  
DIAMOND C UNDIES

DIAMOND C RAZZAMATAZZ  
Dam: SIRLOIN X-ACT  
SIRLOIN LANDLADY

EPD'S:	BW	WW	YW	MK	Actual BW	Wean Weight
	2.1	58	79	21	89	752



## Lot 11 SIRLOIN EXCLUSIVE SFL 112E

March 10, 2017 CPM4090505 Red • Double Polled

EXCEL POLLED POPEYE  
Sire: DIAMOND C BRAVEHEART  
DIAMOND C UNDIES

TOP MEADOW TEMPLATE 18T  
Dam: SIRLOIN WHISTLE  
SIRLOIN TRANQUIL

EPD'S:	BW	WW	YW	MK	Actual BW	Wean Weight
	3.3	53	73	12	94	585



## Lot 12 SIRLOIN ECHO SFL 113E

March 10, 2017 CPM4090506 Red • Double Polled

EXCEL POLLED POPEYE  
Sire: DIAMOND C BRAVEHEART  
DIAMOND C UNDIES

DC XCALIBUR  
Dam: SIRLOIN ZENA SFL 6Z  
SIRLOIN X-TERIOR

EPD'S:	BW	WW	YW	MK	Actual BW	Wean Weight
	1.0	62	96	22	90	781



## Lot 13 SIRLOIN EXCEL SFL 116E

March 11, 2017 CPM4090507 Red • Scurred

EXCEL POLLED POPEYE  
Sire: DIAMOND C BRAVEHEART  
DIAMOND C UNDIES

HUDS TAYLOR  
Dam: SIRLOIN X-AMINE  
DIAMOND C RELEASE ME

EPD'S:	BW	WW	YW	MK	Actual BW	Wean Weight
	3.1	52	77	21	99	758

- Heavy Muscle • Deep • Docile • Thick
- Moves Well • One Of Our Favourites





## Lot 14 SIRLOIN ECLIPSE SFL 120E

March 12, 2017 CPM4090509 Red • Double Polled

EXCEL POLLED POPEYE  
Sire: DIAMOND C BRAVEHEART  
DIAMOND C UNDIES

SIRLOIN KAYO  
Dam: SIRLOIN SILK  
SIRLOIN JANE

EPD'S:	BW	WW	YW	MK	Actual BW	Wean Weight
	4.4	71	105	23	100	765



## Lot 15 SIRLOIN ELIMINATOR SFL 127E

March 12, 2017 CPM4090512 Red • Polled

EXCEL POLLED POPEYE  
Sire: DIAMOND C BRAVEHEART  
DIAMOND C UNDIES

HUDS TAYLOR  
Dam: SIRLOIN X RAY  
SIRLOIN KISS

EPD'S:	BW	WW	YW	MK	Actual BW	Wean Weight
	2.3	50	73	22	91	746



## Lot 16 SIRLOIN EXCELLER SFL 137E

March 15, 2017 CPM4090515 Red • Double Polled

EXCEL POLLED POPEYE  
Sire: DIAMOND C BRAVEHEART  
DIAMOND C UNDIES

ANCHOR B POWERPLAY  
Dam: SIRLOIN TRUMPET  
SIRLOIN PARAKEET

EPD'S:	BW	WW	YW	MK	Actual BW	Wean Weight
	4.1	69	98	18	97	773

- Deep • Thick • Well Put Together
- Awesome Dam



## Lot 17 SIRLOIN EDDY SFL 144E

March 17, 2017 CPM4090518 Red • Double Polled

EXCEL POLLED POPEYE  
Sire: DIAMOND C BRAVEHEART  
DIAMOND C UNDIES

RICHMOND TITAN SRD 4T  
Dam: SIRLOIN WHISPER 22W  
SIRLOIN TRADE SECRET

EPD'S:	BW	WW	YW	MK	Actual BW	Wean Weight
	2.7	61	91	22	96	784

- Super Docile • Good Muscle • Good Shape • Stand Out As Calf
- One Of Our Favourites • Off One Of Our Top Producing Cows





## Lot 18 SIRLOIN ELECTRIC AVENUE SFL 155E

March 22, 2017 CPM4090520 Red • Double Polled

EXCEL POLLED POPEYE  
Sire: DIAMOND C BRAVEHEART  
DIAMOND C UNDIES

DC EXCALIBUR  
Dam: SIRLOIN ZENNA SFL7Z  
SIRLOIN XEROX

EPD'S:	BW	WW	YW	MK	Actual BW	Wean Weight
	-.03	54	84	22	83	693

- Deep • Good Hair • Super Calving Ease On Dam Side
- Could Be Used On Heifers



## Lot 19 SIRLOIN EXCELLER SFL 158E

March 23, 2017 CPM4090521 Red • Double Polled

EXCEL POLLED POPEYE  
Sire: DIAMOND C BRAVEHEART  
DIAMOND C UNDIES

NORDAL TRAILWAYS  
Dam: SIRLOIN AWARD  
SIRLOIN RIBBON

EPD'S:	BW	WW	YW	MK	Actual BW	Wean Weight
	5.0	73	110	17	104	734



## Lot 20 SIRLOIN EXCELLER SFL 165E

March 26, 2017 CPM4090523 Red • Double Polled

EXCEL POLLED POPEYE  
Sire: DIAMOND C BRAVEHEART  
DIAMOND C UNDIES

SIRLOIN KAYO  
Dam: SIRLOIN TEAM  
SIRLOIN KALISTA

EPD'S:	BW	WW	YW	MK	Actual BW	Wean Weight
	2.2	71	102	14	85	782



## Lot 21 SIRLOIN EXCELLER SFL 167E

March 27, 2017 CPM4090524 Red • Double Polled

EXCEL POLLED POPEYE  
Sire: DIAMOND C BRAVEHEART  
DIAMOND C UNDIES

NORDAL TRAILWAYS  
Dam: SIRLOIN YIELDER 74Y  
SIRLOIN TARGET 28T

EPD'S:	BW	WW	YW	MK	Actual BW	Wean Weight
	3.2	66	92	16	96	718





## Lot 22 SIRLOIN EXCELLER SFL 173E

March 29, 2017 CPM4090526 Red • Double Polled

EXCEL POLLED POPEYE  
Sire: DIAMOND C BRAVEHEART  
DIAMOND C UNDIES

JYF NOAH  
Dam: SIRLOIN X-YLOPHONE  
SIRLOIN GENA

EPD'S:	BW	WW	YW	MK	Actual BW	Wean Weight
	1.6	48	70	22	85	657



## Lot 23 SIRLOIN EXCELLER SFL 199E

April 9, 2017 CPM4090531 Red • Double Polled

EXCEL POLLED POPEYE  
Sire: DIAMOND C BRAVEHEART  
DIAMOND C UNDIES

ANCHOR B POWERPLAY  
Dam: ANDREW POWERPIROUETTE 4T  
SIRLOIN PIROUETTE

EPD'S:	BW	WW	YW	MK	Actual BW	Wean Weight
	3.4	57	82	18	91	592



## Lot 24 SIRLOIN EXCELLER SFL 222E

April 24, 2017 CPM4090535 Red • Double Polled

EXCEL POLLED POPEYE  
Sire: DIAMOND C BRAVEHEART  
DIAMOND C UNDIES

TOP MEADOW TEMPLATE 18T  
Dam: SIRLOIN WHISPER 2  
SIRLOIN TIGRESS

EPD'S:	BW	WW	YW	MK	Actual BW	Wean Weight
	2.1	63	90	18	87	622



## Lot 25 SIRLOIN EXTRACTOR SFL 242E

May 9, 2017 CPM4096668 Red • Double Polled

EXCEL POLLED POPEYE  
Sire: DIAMOND C BRAVEHEART  
DIAMOND C UNDIES

DC XCALIBUR  
Dam: SIRLOIN ALANNA  
SIRLOIN YIELDER 107Y

EPD'S:	BW	WW	YW	MK	Actual BW	Wean Weight
	0.3	60	92	22	92	512



# Sirloin Ammo



AMMO is a home raised WULFS WALDO son we used for 2 years until he was injured. He is the son of one of our favourite cows, Sirloin Lifeline. Ammo had a ton of power and muscle, and he has thrown that into his progeny.

REFERENCE SIRE OF LOTS 26 - 30



## Lot 26 SIRLOIN EXCELLER SFL 95E

March 7, 2017 CPM4090502 Red • Double Polled

WULFS WALDO T928W

Sire: SIRLOIN AMMO

SIRLOIN LIFELINE

DC XCALIBUR

Dam: SIRLOIN AMY

SIRLOIN YIELDER 57Y

EPD'S:	BW	WW	YW	MK	Actual BW	Wean Weight
	0.6	52	80	27	90	713



## Lot 27 SIRLOIN EASTON SFL 124E

March 12, 2017 CPM4090511 Red • Scurred

WULFS WALDO T928W

Sire: SIRLOIN AMMO

SIRLOIN LIFELINE

JYF NOAH

Dam: SIRLOIN WREATH

SIRLOIN MARCI

EPD'S:	BW	WW	YW	MK	Actual BW	Wean Weight
	2.7	60	89	24	94	811

• Great Depth • Thick • Tons Of Rib



## Lot 28 SIRLOIN EXCALIBUR SFL 135E

March 15, 2017 CPM4090514 Black • Double Polled

WULFS WALDO T928W

Sire: SIRLOIN AMMO

SIRLOIN LIFELINE

NORDAL NIGHT RIDER

Dam: SIRLOIN POLKA DOT

SIRLOIN MESSAGE

EPD'S:	BW	WW	YW	MK	Actual BW	Wean Weight
	-0.5	59	89	32	86	847

• Only Black 2 Year Old in Sale • Big Muscle • Long Body  
• Calving Ease On Dam Side • Longevity In DNA • Big Milk EPD  
• 17 Year Old Grand Dam Still Working For Us (Dam of Lot 2)





## Lot 29 SIRLOIN EXCELLER SFL 140E

March 16, 2017 CXM4090516 Red • Double Polled

WULFS WALDO T928W  
Sire: SIRLOIN AMMO  
SIRLOIN LIFELINE  
TREF YACHSMAN 031Y  
Dam: SIRLOIN ANDY SFL98A  
SIRLOIN PAPRIKA

EPD'S:	BW	WW	YW	MK	Actual BW	Wean Weight
	1.8	57	88	26	88	724



## Lot 30 SIRLOIN EXCELLER SFL 184E

April 4, 2017 CPM4090528 Red • Double Polled

WULFS WALDO T928W  
Sire: SIRLOIN AMMO  
SIRLOIN LIFELINE  
TREF YUKON JACK 083Y  
Dam: SIRLOIN ACTION  
SIRLOIN X-TRACT

EPD'S:	BW	WW	YW	MK	Actual BW	Wean Weight
	2.5	58	82	22	89	652

- Great Muscle • Good Length • Thick
- Moderate Frame • One Of Our Favourites



## DIAMOND C ZIMBA

We purchased ZIMBA from Diamond C Ranch as a yearling. He was part of their shown string at the time. He was a big brute bull with lots of muscle and hair. ZIMBA's progeny are big and brute just like him, they are pound producers to say the least.

REFERENCE SIRE OF LOTS 31 - 34



## Lot 31 SIRLOIN EXCELLER SFL 45E

February 26, 2017 CPM4090492 Red • Double Polled

DIAMOND C WEAPON  
Sire: DIAMOND C ZIMBA  
LNA NORTH STAR 236N  
HUDS TAYLOR  
Dam: SIRLOIN YIELDER 14Y  
SIRLOIN WREATH

EPD'S:	BW	WW	YW	MK	Actual BW	Wean Weight
	1.7	48	72	23	90	684





## Lot 32 SIRLOIN EXCELLER SFL 82E

March 6, 2017 CPM4090500 Red • Double Polled

DIAMOND C WEAPON  
Sire: DIAMOND C ZIMBA  
LNA NORTH STAR 236N

RICHMOND TITAN SRD 4T  
Dam: SIRLOIN X-TREMELY  
SIRLOIN RACKET

EPD'S:	BW	WW	YW	MK	Actual BW	Wean Weight
	3.0	67	93	21	95	757



## Lot 33 SIRLOIN EXCELLER SFL 108E

March 10, 2017 CPM4090504 Red • Polled

DIAMOND C WEAPON  
Sire: DIAMOND C ZIMBA  
LNA NORTH STAR 236N

JYF NOAH  
Dam: SIRLOIN ZENNA SFL57Z  
SIRLOIN RUFFLE

EPD'S:	BW	WW	YW	MK	Actual BW	Wean Weight
	3.6	70	103	18	94	750



## Lot 34 SIRLOIN EXCELLER SFL 202E

April 10, 2017 CPM4090533 Red • Double Polled

DIAMOND C WEAPON  
Sire: DIAMOND C ZIMBA  
LNA NORTH STAR 236N

NORDAL NIGHT RYDER  
Dam: SIRLOIN SPEARMINT  
SIRLOIN PEPPERMINT

EPD'S:	BW	WW	YW	MK	Actual BW	Wean Weight
	4.5	61	82	24	101	627



Dam to Lot 29



Dam to Lot 30



Dam to Lot 32



Dam to Lot 41



# DC XCALIBUR

XCALIBUR, a ROMN Tow Truck son, was bought from DC farms and we used him for 4 years on heifers with very little issues and then moved him onto some cows. A lot of our top end females are sired by Xcalibur. He has amazing calving ease with a -6.6 BW EPD and his progeny prove that.

REFERENCE SIRE OF LOTS 35 - 37



## Lot 35 SIRLOIN ECCALIBUR SFL 204E

April 11, 2017 CPM4096665 Red • Double Polled

ROMN TOW TRUCK 111T  
Sire: DC XCALIBUR  
DC POLLED LIQUORISH  
WULFS WALDO T928W  
Dam: SIRLOIN ALL STAR  
SIRLOIN ULTIMATE POWRPLAY

EPD'S:	BW	WW	YW	MK	Actual BW	Wean Weight
	-1.7	55	86	29	82	561

• Super Long Body • Lots Of Rib • Good Muscle

## Lot 36 SIRLOIN EXCALIBUR SFL 219E

April 24, 2017 CPM4096666 Red • Double Polled

ROMN TOW TRUCK 111T  
Sire: DC XCALIBUR  
DC POLLED LIQUORISH  
HUDS TAYLOR  
Dam: SIRLOIN X-AM  
SIRLOIN PICCOLO

EPD'S:	BW	WW	YW	MK	Actual BW	Wean Weight
	-1.4	40	62	28	91	611

• Deep • Thick Top • Awesome Muscle Shape  
• Really Eye Appealing

## Lot 37 SIRLOIN EXCALIBUR SFL 226E

April 26, 2017 CPM4096667 Red • Double Polled

ROMN TOW TRUCK 111T  
Sire: DC XCALIBUR  
DC POLLED LIQUORISH  
HUDS TAYLOR  
Dam: SIRLOIN ZENNA SFL70Z  
SIRLOIN MAISSA

EPD'S:	BW	WW	YW	MK	Actual BW	Wean Weight
	-3.3	40	62	30	75	571

• Moderate Frame • Nice Depth • Super Calving Ease  
• Big Milk EPD • Could Be Used On Heifers







## Lot 38 SIRLOIN EDDIE SFL 20E

February 9, 2017 CPM4092665 Red • Double Polled

RPY PAYNES DERBY 46Z  
Sire: DC COMANCHE 78C  
DC SWEET SURRENDER

WULFS WALDO T928W  
Dam: SIRLOIN CHERISH  
SIRLOIN WIGGLE

EPD'S:	BW	WW	YW	MK	Actual BW	Wean Weight
	0.1	56	83	25	82	725

- Great Shape • Great Muscle • Deep
- Moderate Frame



## Lot 39 SIRLOIN EXCELLER SFL 59E

March 2, 2017 CPM40902667 Red • Double Polled

RPY PAYNES DERBY 46Z  
Sire: DC COMANCHE 78C  
DC SWEET SURRENDER

WULFS WALDO T928W  
Dam: SIRLOIN CARE  
ANDREW PANPLAYER 10T

EPD'S:	BW	WW	YW	MK	Actual BW	Wean Weight
	-.02	44	67	24	80	545

- Great Shape • Good Muscle • Moderate Frame

LOT 40 SIRED BY PINNACLES ALL IN 12A



## Lot 40 SIRLOIN EXCELLER SFL 117E

March 12, 2017 CPM4090508 Red • Double Polled

WULFS XTRACTOR X233X  
Sire: PINNACLES ALL IN 12A  
TMF MISS 2X

WULFS WALDO T928W  
Dam: SIRLOIN BRIDE SFL 116B  
SIRLOIN WHIZZ

EPD'S:	BW	WW	YW	MK	Actual BW	Wean Weight
	1.3	70	108	20	89	748







## HILLVIEW YOUR PICK

We purchased YOUR PICK from Hillview Farms and we used him on cows. He was heavy muscled, moderate framed and his progeny are very similar. We have many females working for us now and they have nice udders with adequate milk. REFERENCE SIRE OF LOT 41



PATERNAL SIBLING TO LOT 41

### Lot 41 SIRLOIN EXTRACTOR SFL 30E

February 21, 2017 CPM4096663 Red • Double Polled

Sire: HILLVIEW YOUR PICK  
HILLVIEW POLLED PANDORA

Dam: SIRLOIN ZEENA SFL123Z  
SIRLOIN LISA

EPD'S:	BW	WW	YW	MK	Actual BW	Wean Weight
	2.5	63	88	13	90	689

• Last Of 411Y Sons • Nice Depth • Good Muscle

## SIRLOIN BULLS EYE

BULLS EYE is a home raised bull sired by HILLVIEW YOUR PICK. His dam SIRLOIN POLKA DOT is a farm favourite and still is producing some of the best calves every year (Lot 28). BULLS EYE was very heavy muscled, long bodied bull. He was injured early on in breeding season so unfortunately, we had very few calves sired by him. REFERENCE SIRE OF LOT 42



### Lot 42 SIRLOIN BULLS EYE SFL 176E

March 30, 2017 CPM4096664 Red • Double Polled

Sire: SIRLOIN BULLS EYE  
SIRLOIN POLKA DOT

Dam: SIRLOIN YIELDER SFL 84Y  
SIRLOIN SPEARMINT

EPD'S:	BW	WW	YW	MK	Actual BW	Wean Weight
	2.4	65	88	23	86	623

• Only Bulls Eye Son Because He Got Injured • Heavy Muscle  
• Deep • Thick Top • Great Shape • Super Docile  
• One of Our Favourites





## ROMN CADILLAC JACK 101C

CADILLAC JACK has big scrotal, heavy muscle, and is a homo polled Wulfs Apostle son. We purchased Jack semen from Excel Ranches hoping to bring in some quality new bloodlines and that is what we got. We only had one calf this year from him, but he is a good one! Tons of calving ease, super docile and awesome muscle shape. We can't wait to have more Cadillac Jack calves in the future.

REFERENCE SIRE OF LOTS 43



### Lot 43 777 CATTLE JACK DANIELS TSC 1F

January 12, 2018 CPM4096338 Red • Homo Polled

WULFS APOSTLE T343A

Sire: ROMN CADILLAC JACK  
ROMN RITA 28R

BLUEBERRY'S UNIFORM POWER

Dam: EXCEL POLLED XMAY  
EXCEL POLLED UMay

EPD'S:

BW	WW	YW	MK	Actual BW	Wean Weight
-1.7	48	70	29	68	735

- Homo Polled • Great Length • Big Hip • Super Docile
- New Genetics • Big Time Calving Ease • Great Producing Dam
- Definitely A Favorite • Big Milk EPD



### Lot 44 777 CATTLE FIREBALL TSC 2F

January 17, 2018 CPM4096439 Red • Homo Polled

EXCEL POLLED POPEYE

Sire: DIAMOND C BRAVEHEART  
DIAMOND C UNDIES

WULFS X FACTOR 7523X

Dam: EXCEL POLLED ASIA  
EXCEL POLLED RANSOM

EPD'S:

BW	WW	YW	MK	Actual BW	Wean Weight
2.7	57	84	24	98	729

- Homo Polled • Deep • Good Hair • Good Shape
- Stand Out From Birth





## EXCEL POLLED BARN BURNER

BARN BURNER is a bull that was raised by Excel Ranches and sold to a commercial producer near Westlock. Excel thought so much of him that they used him on some of their own cows. We ended up buying a few of those cows. Barn Burner is heavy muscled, deep bodied and super docile. His heifers are well built and have beautiful udders with lots of quality milk. REFERENCE SIRE OF LOT 45



### Lot 45 777 CATTLE ELECTRIC AVENUE TSC 9E

February 19, 2017 CPM4090734 Red • Double Polled

WULFS XANDREW 8401X

Sire: EXCEL POLLED  
BARN BURNER  
EXCEL POLLED UTAH

DC POLLED SNIPER

Dam: EXCEL POLLED XYLEM  
EXCEL POLLED THIMBLE

EPD'S:

BW	WW	YW	MK	Actual BW	Wean Weight
1.2	58	92	19	94	724

• Deep • Thick • Good Muscle • Docile • Sire Has Proven To Produce Awesome Females at Commercial Ranch Near Westlock





**Murray, Bev, Bryce, & Kallie Stewart**

**HOME 403-742-5226**

**MURRAY 403-742-9813**

**stewartlimousin@gmail.com**



**Tyler and Claire Stewart**

**TYLER 403-741-9571**

**BRYCE 403-740-2638**

**Selling Limousin Breeding Stock Since 1970**

**Internet Bidding Available**

**D | L | M | S**  
*www.dlms.ca*

**For more information Call DLMS Reps:**

**Mark Shologan 780.699.5082**

**Whitney Bosovich 780.991-3025**

**STEWART LIMOUSIN**

**BOX 1326**

**STETTLER, AB**

**T0C 2L0**